

# Artist's Brief

## Youth Justice Facility New Development

<b>Commission</b>	Indoor artworks and digital files for integrated artworks
<b>Eligibility</b>	Tasmanian artists who meet our general eligibility criteria: <a href="http://www.arts.tas.gov.au/grants_and_funding/general_eligibility">www.arts.tas.gov.au/grants_and_funding/general_eligibility</a>
<b>Selection process</b>	<p>The selection committee will consider all eligible applications against the selection criteria. The committee will then:</p> <ul style="list-style-type: none"><li>• select one artist to complete both Part A and B of the commission, OR</li><li>• select one artist for each part of the commission, OR</li><li>• shortlist up to three artists for each part of the commission to develop ideas further (each shortlisted artist will receive a fee of \$500).</li></ul>
<b>Location</b>	466 Brighton Road, Pontville
<b>Audience</b>	Children and young people who require care within a secure environment, families and other visitors (of all ages) of those children and young people, staff and visiting professionals.
<b>Fee</b>	Part A – \$36,000 (Ex GST) Part B – \$36,000 (Ex GST)
<b>Key dates</b>	Applications close: <b>Monday 4 May 2026</b> , 11.59pm Shortlist presentation due: 1 June 2026 DDP presentation by: 13 July 2026 Digital artwork files delivered by: Mid-August 2026 (TBC) Artwork installed by: Mid 2027 (TBC)
<b>Contact</b>	Tobias Hengeveld Public Art and Industry Development Coordinator, Arts Tasmania Ph 03 6165 5556 <a href="mailto:tobias.hengeveld@arts.tas.gov.au">tobias.hengeveld@arts.tas.gov.au</a>
<b>Apply</b>	<a href="http://www.arts.tas.gov.au/public_art">www.arts.tas.gov.au/public_art</a>

# The commission

Arts Tasmania and the Department for Education, Children and Young People invite applications from Tasmanian artists to create interior artwork and digital designs to be integrated into the building's fabric at the new Youth Justice Facility in Pontville.

The commission is in two parts:

**Part A:** a wall-based or suspended artwork in the public entry building, plus a design for perforated steel screening or pre-cast concrete.

**Part B:** a two-dimensional wall-based work in a selection of communal spaces, plus a design for window film or frosting

Applicants can apply for the commission as individual artists or in creative collaborations.

Shortlisted and selected artists may be required to prepare elements of their concept material for consideration by children and young people to inform the process of selection and design development.

## Background

The Department for Education, Children and Young People is committed to closing the Ashley Youth Detention Centre (AYDC) and replacing it with a new secure detention facility that promotes the development of trusting and therapeutic relationships between staff, children and young people. The decision to close the AYDC and build a new facility aligns with the recommendations of the Youth Justice Blueprint and the Tasmanian Government's Commission of Inquiry. These recommendations prioritise therapeutic trauma-informed approaches. Evidence shows that therapeutic approaches prevent reoffending and keep the community safer.

The new facility will play a role in the broader reforms to Tasmania's youth justice system. The main focus of the reforms is on diversion and early intervention, with detention being a last resort. The new facility will focus on providing care for the small number of children and young people who need secure accommodation, within a therapeutic, trauma-informed and culturally safe environment.

The purpose of the new Tasmanian Youth Justice Facility (the Facility) is to provide:

- A safe, secure and rehabilitative facility for children and young people where healing and wellbeing is the primary focus.
- An environment where children and young people are supported to address their offending behaviour and successfully return to be part of the community and live bright lives and positive futures.
- An environment where children, young people, staff and visitors feel safe and supported.
- The community with confidence that children and young people in detention are in a safe, purpose-built facility that provides a high standard of care and rehabilitation support.

### Overarching design principles for the new Facility

The Facility will have a non-institutional feel and be low-lying in the landscape. A 'Building as Perimeter' model has been adopted, which means that views from bedrooms and living areas will be directly out into the landscape, with far reaching views to mountains and surrounding rural land.

The design takes cues from local rural building traditions, establishing a built environment that resonates with the surrounding landscape while remaining practical and contextually grounded.

The assortment of buildings will be akin to that of a small farm, with volumes similar to barns, homesteads and sheds.

The integration of natural light, views to nature and access to outdoor spaces supports an experience of place that promotes independence and a connection to nature, reinforcing the Facility's therapeutic intent.

## Objectives

For each part of this commission, the successful artist will develop, fabricate and install an artwork. The artwork concept will also extend into a design that is integrated into specific material elements of the building at construction stage (in collaboration with the project team). For this component the artist will provide a finished digital artwork file (to required specifications). The fabrication and installation costs will be covered by the project.

The artwork concept could respond to the key themes and design principles of the project and complement the building and landscape design of the Facility.

Some suggested conceptual approaches include themes that:

- are culturally and environmentally meaningful and relevant to the site and its rural setting
- reflect and support the therapeutic intent of the new Facility
- promote hope, positivity, agency, self-worth, care, family and community.

Applicants are encouraged to consider how their artwork concept will be linked and consistent across both components of its application (i.e. physically installed and integrated as a design).

### Part A:

A wall-based or suspended artwork in the public entry building, plus a design for perforated steel screening or pre-cast concrete (locations and details to be provided by the project team).

See **Project document 1** for indicative image.

### Part B:

A two-dimensional wall-based work in a selection of communal spaces, plus a design for window film or frosting (locations and details to be provided by the project team).

See **Project document 2** for indicative images.

## Apply

Please provide a CV, examples of relevant artwork and some information about how you would approach the commission via [our website](#).

# How it works

## Project team

The project team is a resource to help you realise your design and meet the project objectives:

- Alex Newman – Director, XSquared Architects
- Bryce Taplin – Project Manager, Department for Education, Children and Young People
- Sam Ledger – Director Operational Commissioning, Department for Education, Children and Young People
- Tobias Hengeveld – Public Art & Industry Development Coordinator, Arts Tasmania

## Selection

The project team will choose an artist to work on the commission using the following criteria:

<b>SUITABILITY</b>	To what extent do the artistic concept, design, materials, and delivery method address the brief?
<b>VIABILITY</b>	How feasible is the project given the commission budget, constraints, and timelines?
<b>CAPABILITY</b>	To what extent does the team demonstrate the necessary skills and experience to deliver the commission?
<b>VISION</b>	How well does the proposal demonstrate a creative or innovative vision in terms of concept, media, construction methods, materials and/or collaborations?

Please note that members of the project team may nominate a colleague to participate in the selection process on their behalf.

**As a component of selection process and design development, concepts may be presented to children and young people within the AYDC for their input on what they would like to see in the new facility.**

# Commissioning process

## Commission agreement

If you are selected to work on the commission, you will be asked to:

- meet with Arts Tasmania to discuss arrangements for the commission, such as payment instalments, roles and responsibilities and insurance
- sign a commissioning agreement to confirm this information in writing.

## Detailed design development

Once you have signed the commission agreement you will be asked to:

- work with the Facility Designer to identify the likely locations the design may be used
- produce a detailed design plan to realise your concept, including artwork specifications such as drawings
- make sure that the artwork design meets all relevant building standards
- report regularly to the selection committee as the commission progresses
- manage all aspects of design through to handover of the completed artwork.

## Fabrication and installation

Once your detailed design has been approved by the project team, you will be asked to:

- fabricate your artwork according to the detailed design plan
- undertake the installation in consultation with the Department and its Contractor
- meet all work health and safety and other requirements while on site
- keep Arts Tasmania updated on your progress and let us know as soon as possible if you need to vary the approved design or timeframe.
- **NOTE:** Your role will not include fabricating and installing the digital artwork design component. However, you may be asked to consult with the project team through the development and file delivery stages.

## Handover your artwork

Let Arts Tasmania know as soon as possible when you are ready to complete your artwork so we can:

- make sure it meets the approved detailed design plan
- provide you with a handover certificate
- document it for our records
- promote it.

# General information

## The Tasmanian Government Art Site Scheme

This commission is supported through the Tasmanian Government Art Site Scheme. For information about the scheme please visit [the Arts Tasmania website](#).

## Aboriginal and Torres Strait Islander content

If your activity involves Aboriginal or Torres Strait Islander content, your application must provide evidence of how you are working with the Aboriginal community. Please refer to Creative Australia's [Protocols for using First Nations cultural and intellectual property in the arts](#).

The Tasmanian Government's [Office of Aboriginal Affairs](#) can provide advice on working with Aboriginal people and organisations.

## Code of practice

We encourage artists and arts organisations to comply with the National Association for the Visual Arts (NAVA)'s [Code of Practice for Visual Arts, Craft and Design](#).

## Workplace health and safety

Siting artworks in the public domain can result in safety risks for the public and for artists. The Department of State Growth requires that commissioned artists comply with Tasmania's [Work Health and Safety laws](#) and the [State Growth Work Health and Safety Contractor Standards](#).

If selected for the commission, you will need to have public liability insurance cover of at least \$10 million.

## Working with vulnerable people

The *Registration to Work with Vulnerable People Act 2013* aims to protect vulnerable persons, including children and young people, from the risk of harm. It requires those working with children and young people to have a current registration and [Working with Vulnerable People \(WWVP\) card](#).

Please visit our website to see Arts Tasmania's [policy on working with children and young people](#)

# Project documents

## Project document 1: Part A – wall-based and/or suspended artwork



Approximate wall area: H3.5m x W5.5m

**Project document 2: Part B – two dimensional wall-based artworks**

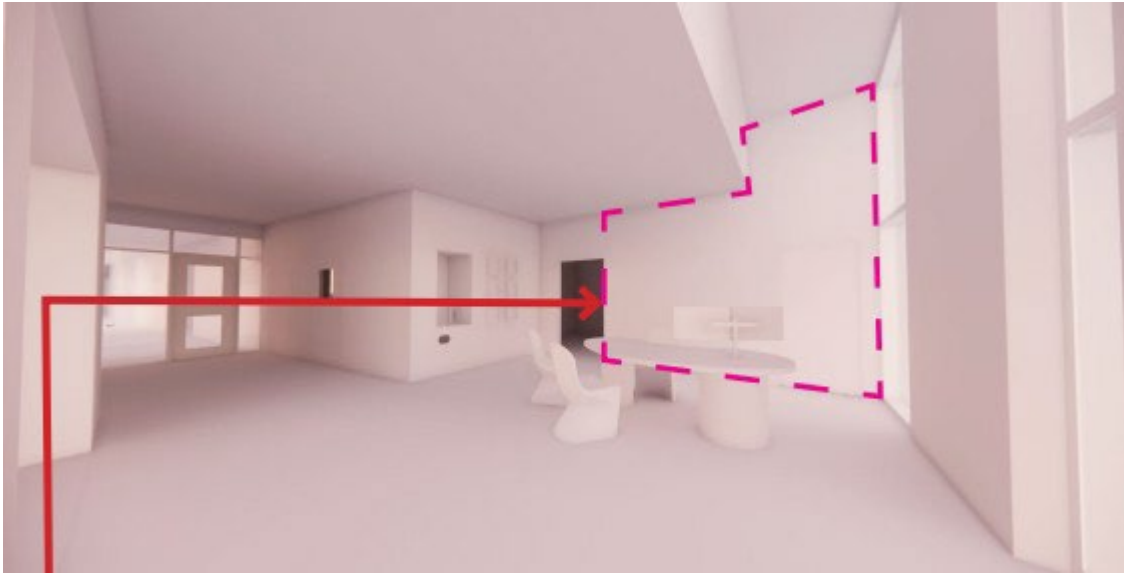

Approximate wall area: H2.8m x W3m

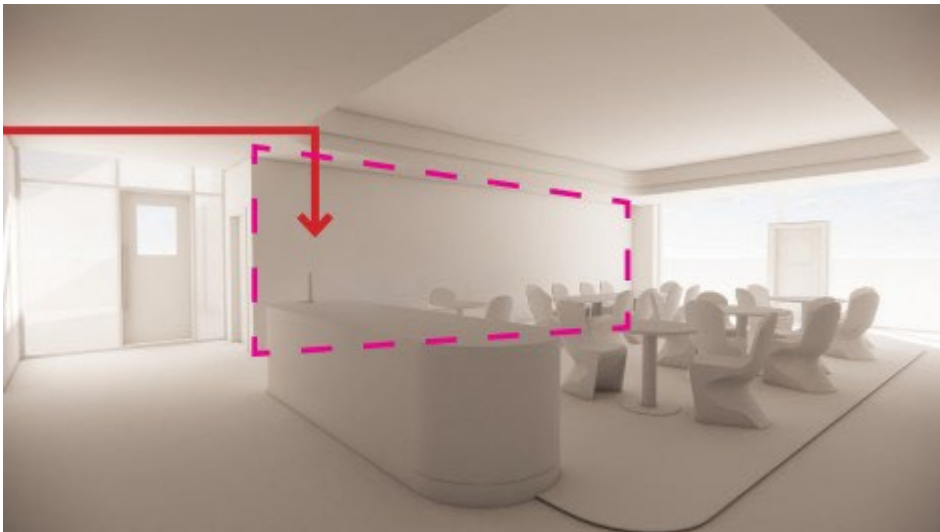

Approximate wall area: H2.8 x 9.7m

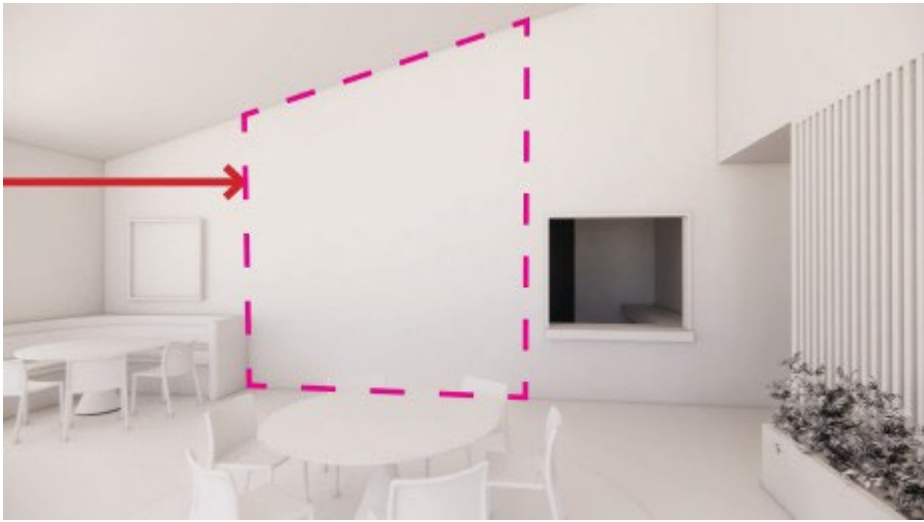

Approximate wall area: H3.9 / 4.9m x W5m